



Project 1 Lighting 1

Client: Karlie Kloss

Designer: Isabelle Sichler

Professor: Eric Chenault

Client & Analysis

Client Profile:

Client name: Karlie Kloss

Location: New York City

Client Overview: Model, Entrepreneur,
Founder of Kode with Klossy



Site Analysis:

Karlie lives in NYC and the plan is to design her bedroom, living room and kitchen.

Her apartment is in the West Village and also draws inspiration from the neighborhood environment.

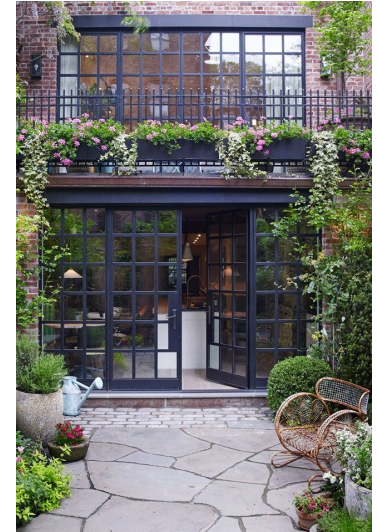

Concept Statement

The design concept is chic modern. Karlie is a fashion model and has a very modern style. The palette will remain more neutral with a mix of materials. An eclectic range of lighting will create an inviting and chic space where Karlie can relax. The tones of light will be soft and mostly be incandescent and LEDs. The kitchen will have various task lighting installations which will make it a very comprehensive space.

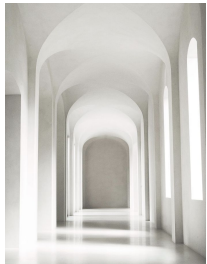
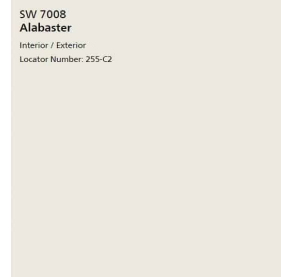
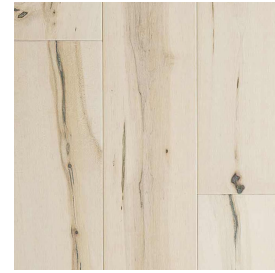
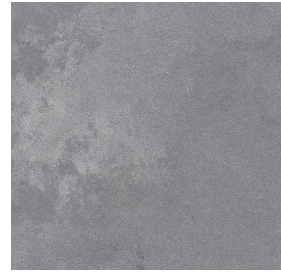

Floor Plan and Lighting Floor plan

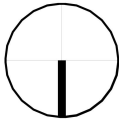

Lighting plan specifics:



Living Room Lighting:

- Large central pendant over black marble table
- 4 Recessed round lights
- Double pendant in between side chairs
- Track lighting on artwork on the wall

Bedroom Lighting:

- Large central pendant
- 4 Recessed round lights
- Double pendant over Eames Lounge chair
- Recessed wall grazing the wall over bed
- 2 Movable wall pendants on each side of the bed

Kitchen Lighting:

- Recessed round lighting
- 3 Pendants over the island
- Recessed lighting toe-kick
- Recessed lighting underneath upper cabinets
- 2 Downlights on each side of the stove

Dining Room:

- Large central pendant
- Recessed light over credenza

Perspective Living Room



Perspective Living Room at Night



Living Room Lighting Specs

CRI: 90
Wattage: 9 Watts
Lumens: 600 Lumens
Beam Spread: 24°
Color Temperature: 3000K

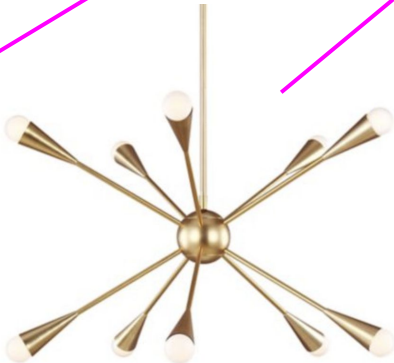

Voltage: 120/277 50/60 Hz
Dimming: 5-Wire 0-10V Dimming
Operating Temperature: 14°F(-10°C) - 176°F (80°C)
CRI: 80

| Lamp Type | Total Lumens | # of Bulbs | Bulb Type | Volts | Color Temp |
|--------------|--------------|------------------|-----------------|-------|-------------|
| Incandescent | 2590.0 | 7 (Not Included) | 40W CA9 1/2 E12 | 120 | 2700 (Warm) |

| Option | Lamp Type | Total Lumens | # of Bulbs | Bulb Type | Volts | Color Temp |
|--------|--------------|--------------|-------------------|-----------------|-------|-------------|
| Large | Incandescent | 6960.0 | 12 (Not Included) | 60W G16 1/2 E12 | 120 | 2700 (Warm) |

| Lamp Type | Total Lumens | # of Bulbs | Bulb Type | Volts | Color Temp |
|-----------|--------------|------------------|-------------|-------|-------------|
| LED | 1500.0 | 1 (Not Included) | 11W A21 E26 | 120 | 2700 (Warm) |

Perspective Bedroom



Perspective Bedroom at Night



Bedroom Lighting Specs

Voltage: 120/277 50/60 Hz
Dimming: 5-Wire 0-10V Dimming
Operating Temperature: 14°F(-10°C) - 176°F (80°C)
CRI: 80

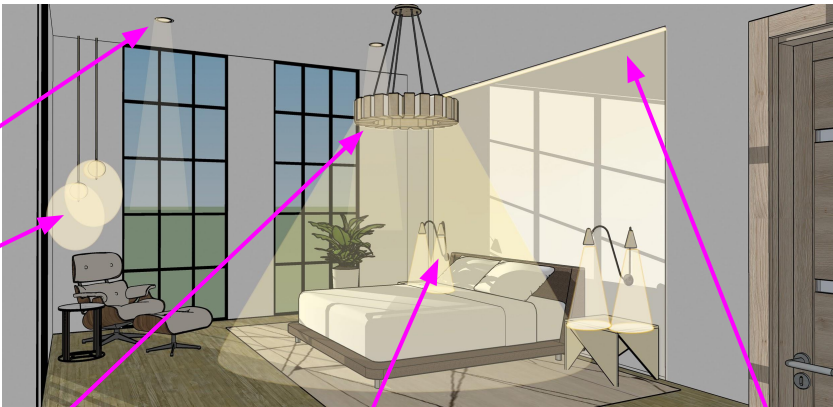

Bulb:

B10 Incandescent

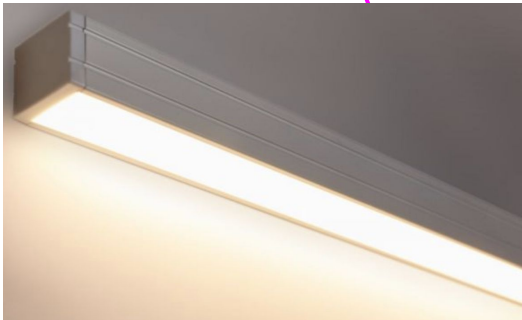

Voltage: 120V
Lumens: 750 Lumens per foot
Wattage: 10W per foot
Dimming: ELV / TRIAC
Color Temperature Switch: Switchable from 3000K, 3500K and 4000K
Max Run Length: Linkable up to 400W

| Lamp Type | Total Lumens | # of Bulbs | Bulb Type | Volts | Color Temp |
|-----------|--------------|------------------|-------------|-------|-------------|
| LED | 1500.0 | 1 (Not Included) | 11W A21 E26 | 120 | 2700 (Warm) |

| Lamp Type | Total Lumens | # of Bulbs | Bulb Type | Volts | Color Temp |
|--------------|--------------|------------------|-------------|-------|-------------|
| Incandescent | 350.0 | 2 (Not Included) | 25W A15 E26 | 130 | 2700 (Warm) |

Perspective Kitchen

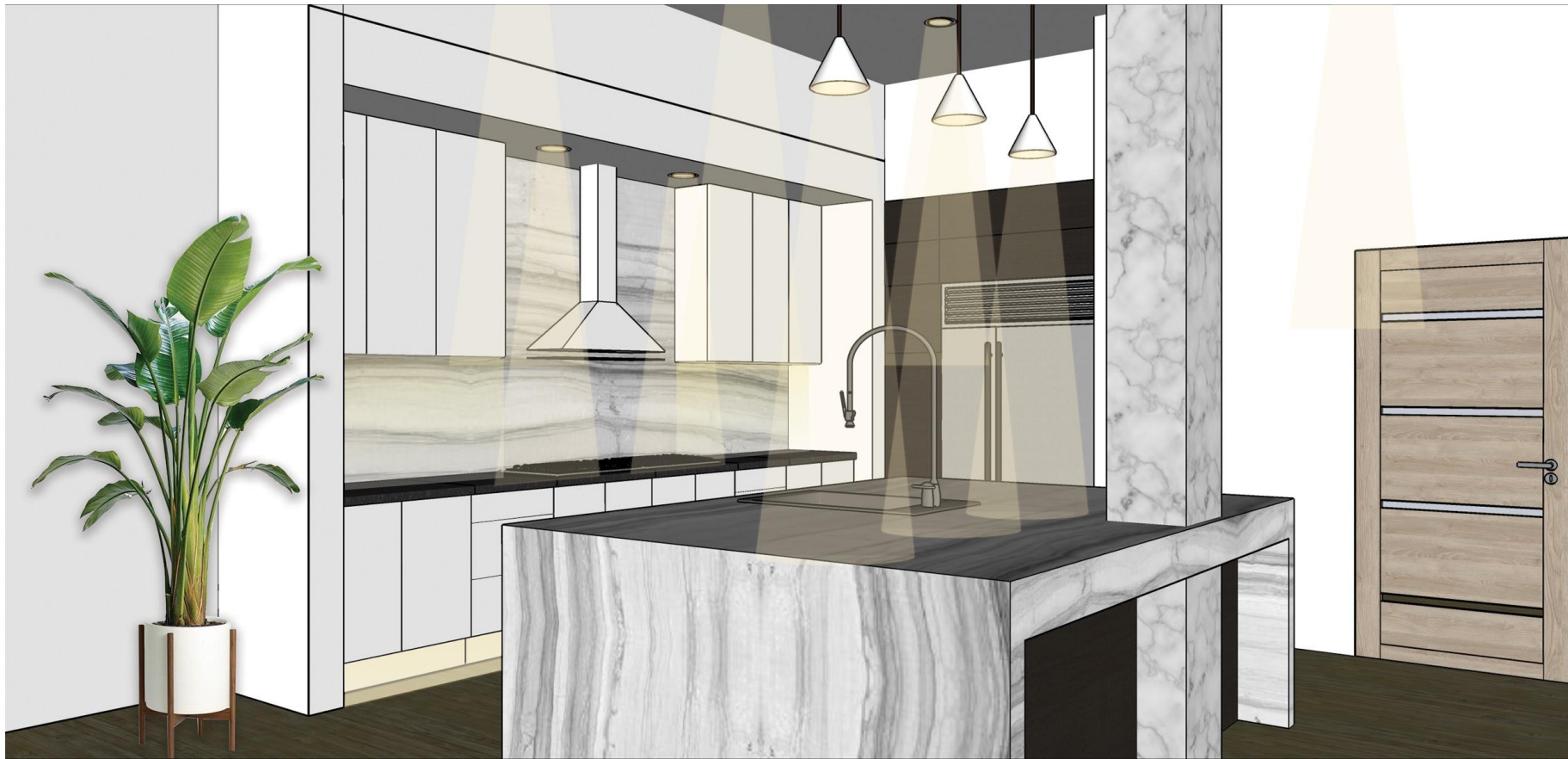

Perspective Kitchen at Night

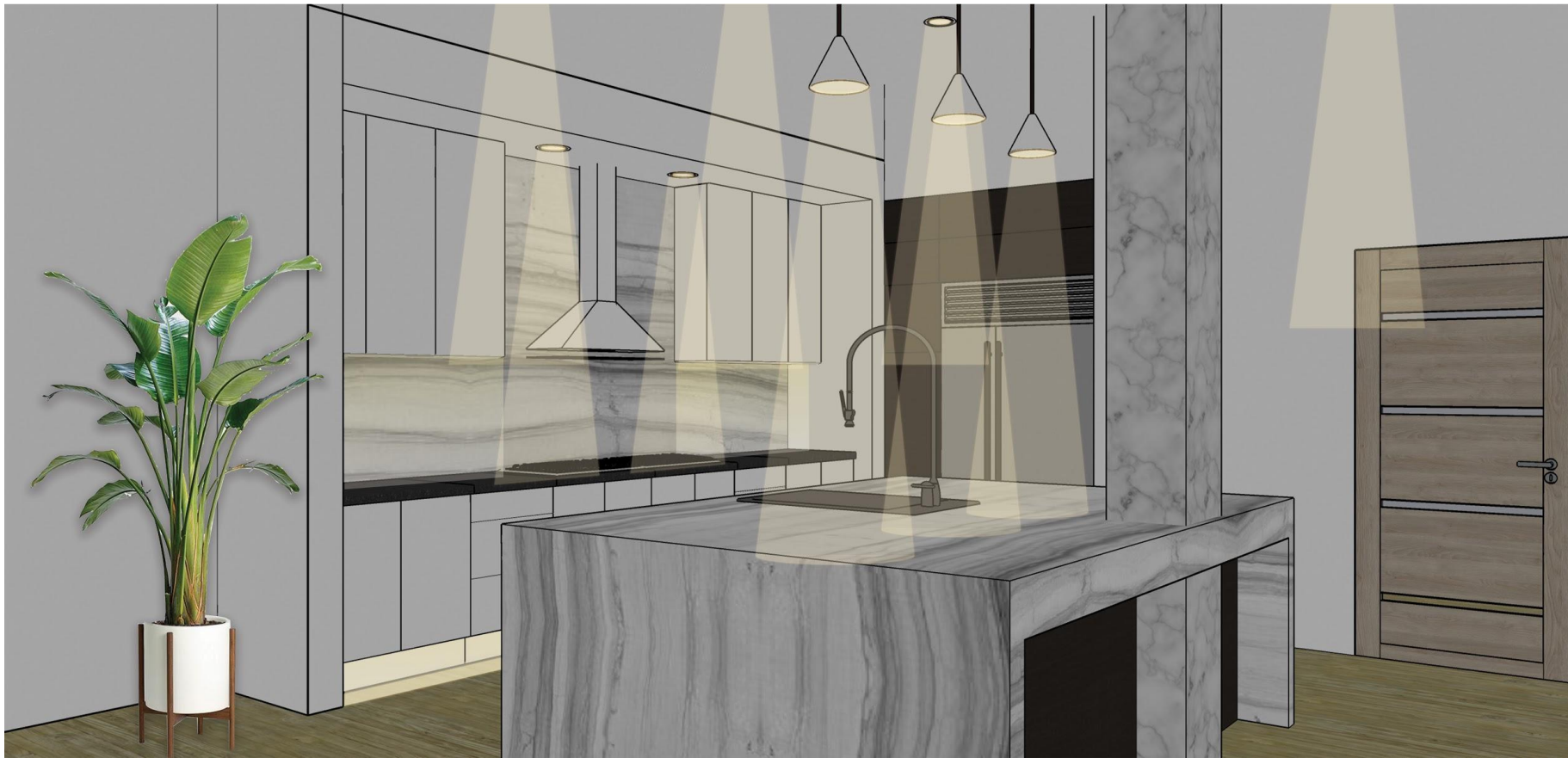

Kitchen Lighting Specs

Voltage: 120/277 50/60 Hz
Dimming: 5-Wire 0-10V Dimming
Operating Temperature: 14°F(-10°C) - 176°F (80°C)
CRI: 80

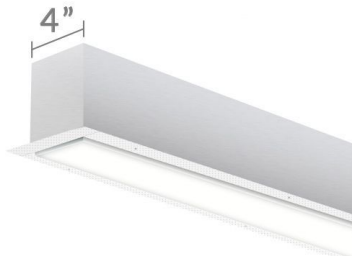
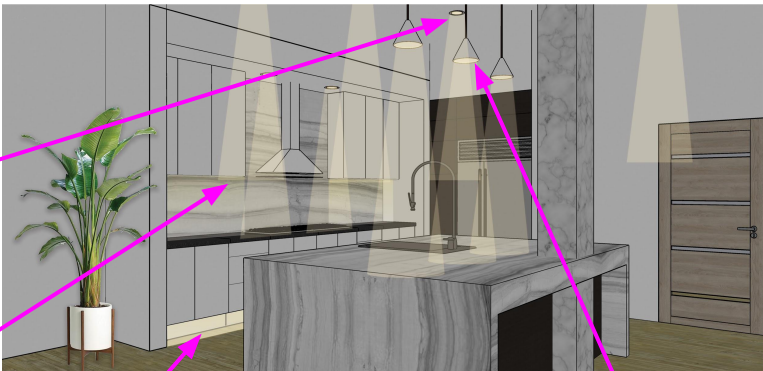

CRI: 80+ & 90+
Life: +60,000 Reported L70 Hours @ 55°C
Operating Temperature: 4°F (-20°C) ~ 122°F (50°C).

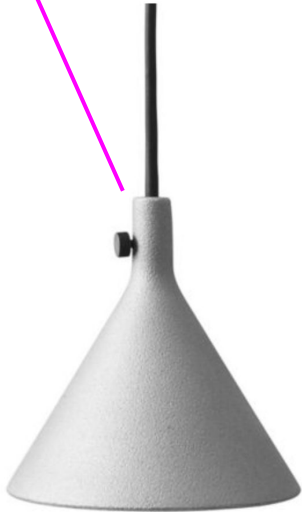

| Lamp Type | Total Lumens | # of Bulbs | Bulb Type | Volts | Color Temp |
|-----------|--------------|------------------|-----------|-------|-------------------|
| LED | 340.0 | 1 (Not Included) | 5W T4 G9 | 120 | 3000 (Soft White) |

Materials & Furniture Specs

The lighting highlights the neutral material palette by enhancing it with incandescent and LED lighting. The kelvins range from 2700-3000. The kitchen has brighter lighting for this space and is used for many tasks. The bedroom has dimmable lights and task lighting on each side of the bed.

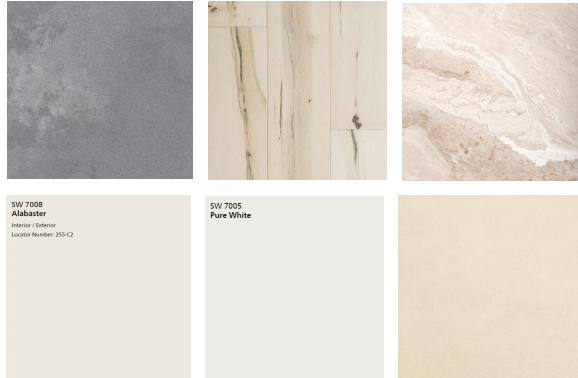

| Treatment | Method |
|---|---|
| Living Room | |
| Daylight | Indirect ambient lighting - large windows - controllable through light window treatments. This will allow for the mood of the room to change and the electrical features to also change throughout the day. |
| General lighting which lights the space day or night | Round recessed lighting spaced throughout the space. This provides ambient lighting that is controllable and dimmable throughout the day. |
| Lighting for the reading chair to be able to have direct lighting | Task lighting - a pendant hanging over the reading chair. This allows for more direct light is you are reading. |
| Lighting for artwork in space to further highlight these pieces | Adding recessed track lighting to light artwork on walls. This is task lighting with the job of highlighting the art on the walls in a gallery wall. |



| Treatment | Method |  |
|---|---|---|
| Bedroom | | |
| Daylight | Natural daylight through broad windows which have blackout shades and grommet drapery for looks | |
| Lighting for reading while in bed. Should be moveable for functionality | Two wall pendants on each side of the bed for reading with led lighting | |
| Lighting to provide further design quality and for sparkle effect | Wall grazing light over bed to create a mood and enhance the symmetry of the space. | |
| General lighting which lights the space day or night | Round recessed lighting spaced throughout the space. This provides ambient lighting that is controllable and dimmable throughout the day. | |

| Treatment | Method |
|---|---|
| Kitchen | |
| Daylight | Natural daylight with no shades. This is in a space with no many windows but the natural daylight flows from the open floor plan and close proximity to the dining room |
| Lighting for nighttime and wayfinding | Recessed lighting for toe-kick in the kitchen to leave on at night and wayfind |
| Lighting above the island for design but also provides additional light | 3 Pendants which are for functionality and design |
| Lighting over the sink and stove for tasks | Recessed round lighting above the sink and stove |
| General Lighting which lights the space day or night | Recessed round lighting over the circulation around the kitchen |
| Lighting for the countertops and doing tasks there | Under cabinet recessed lighting for night time and countertop cooking |

